



## Standard

- All steel frame
- Stroke adjustment by DRO
- Manual working system
- All tooling and pins are induction hardened and grinded
- Foot pedal operated
- Comes with 1 set of press brake tooling
- Brake gauge
- NC controller

## Optional

- Automatic working system
- Cutting, punching, straightening, pipe bending tools



# HZ-FAB 44

 Technical Specifications	HZ11	HZ22	HZ33	HZ44	HZ55	HZ88	HZ110
Max Pressure at 200 Bar	11 ton	22 ton	33 ton	44 ton	55 ton	88 ton	110 ton
Oil Tank Capacity	3 gal	3 gal	10 gal	10 gal	15 gal	31 gal	31 gal
Bending capacity (Flat Material)	6" x 0.31"	8" x 0.5"	8" x 0.70"	8" x 1"	12" x 0.59"	12" x 1"	12" x 1.25"
Bending Capacity (Round Tubes)	1.65" x 0.12"	1.88" x 0.15"	2.36" x 0.15"	2.36" x 0.19"	2.99" x 0.15"	3.54" x 0.35"	4.48" x 0.39"
Max Stroke	7.2"	7.2"	11.25"	11.25"	11.25"	11.25"	11.25"
Bolt Diameter	2.3"	3"	3"	3"	3.5"	4"	4"
Tooling Height	6"	8"	9.75"	9.75"	12"	12"	12"
Operation Speed	0.39 in/s	0.39 in/s	0.39 in/s	0.39 in/s	0.39 in/s	0.39 in/s	0.39 in/s
Return Speed	0.39 in/s	0.39 in/s	0.39 in/s	0.39 in/s	0.39 in/s	0.39 in/s	0.39 in/s
Motor Power	1.5 Hp	3 Hp	4 Hp	5.5 Hp	7.5 Hp	13.5 Hp	13.5 Hp
Net Weight	550 Lbs	1170 Lbs	2315 Lbs	2425 Lbs	3195 Lbs	3750 Lbs	3750 Lbs
Table Size (L x W)	1'6" x 2'11"	1'6" x 3'5"	2'1" x 4'1"	2'1" x 4'1"	2'2" x 4'1"	2'5" x 4'8"	2'5" x 4'8"
Working Height	3 ft	3ft 0.61"	3ft 0.61"	3ft 0.61"	3ft 0.61"	3ft 0.61"	3ft 0.61"
Machine Length	2'11"	3'9"	4'1"	4'1"	4'7"	4'8"	4'8"
Machine Height	3'8"	3'11"	4'1"	4'1"	4'7"	4'8"	4'8"



*Fiber Lasers*



*Press Brakes*

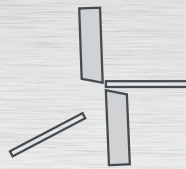

*Shears*

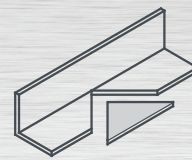

*Ironworkers*

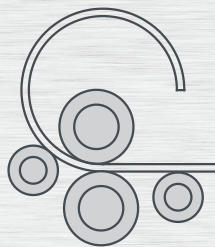

*Plate Rolls*



*Angle Rolls*

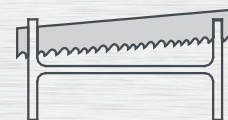

*Bandsaws*



*Dishing Presses*

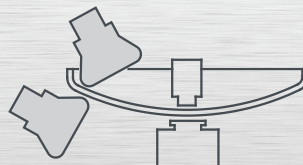

*Flanging Machines*

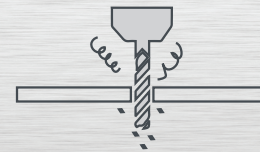

*Drilling Machines*

*"If you need a machine and don't buy it, you'll find that you have paid for it anyway, but don't have it."*

*Henry Ford*

[www.RMTUS.com](http://www.RMTUS.com)  
info@rmtus.com

Phone: 844.RMT.INFO  
844.768.4636

**KYSON**

844-768-4636 / [www.RMTUS.com](http://www.RMTUS.com)