

R-HYBRID

VARIABLE GEOMETRY HYDRAULIC THREE ROLLS

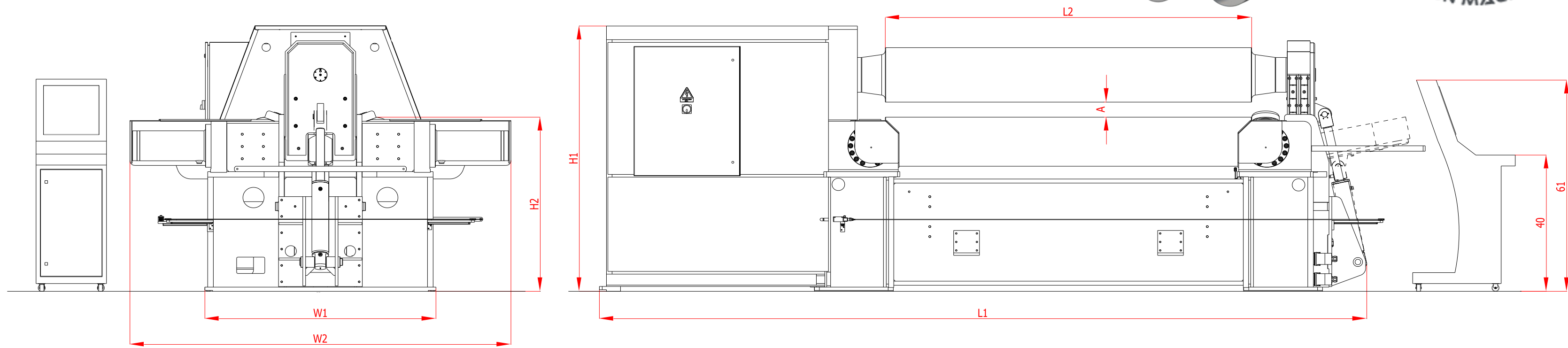
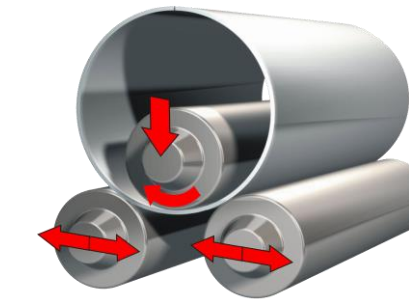

MODEL TYPE	Bending Length	Min. Int. Dia Ø Dmin			Top Roll Ød (inch)	Lower Rolls Ø (inch)	Top Roll Bending Force US Tons	Max. Pass Through A (inch)	Length L1 (inch)	Width W1 (inch)	Total Width W2 (inch)	Height H1 (inch)	Working Height H2 (inch)	Weight (Lbs)	Main Motor (HP)	Hydraulic Tank Capacity (l)
		Ødx1,5	Ødx5	Ødx5												
		Pre-Bending Capacities	Pre-Bending Capacities	Bending Capacities												
R-HYBRID 8-1377	8' 6"	3/4"	7/8"	1-1/8"	13.77"	12.99"	187	4"	192"	65"	106"	77"	49"	36,486	40	106
R-HYBRID 8-1575	8' 6"	1"	1 3/16"	1 9/16"	15.75"	14.17"	231	4"	215"	65"	106"	77"	50"	40,786	50	106
R-HYBRID 8-1772	8' 6"	1 3/16"	1 7/16"	1 7/8"	17.72"	16.54"	286	4-3/4"	220"	73"	114"	86"	57"	51,147	60	159
R-HYBRID 8-1969	8' 6"	1 3/8"	1 5/8"	2 5/32"	19.69"	18.11"	352	5-3/8"	228"	78"	121"	94"	61"	67,241	75	198
R-HYBRID 8-2205	8' 6"	1 9/16"	1 7/8"	2 3/8"	22.05"	19.69"	484	6"	238"	89"	139"	105"	69"	93,696	60+25	238
R-HYBRID 10-1377	10' 2"	5/8"	3/4"	1"	13.77"	12.99"	176	4"	214"	65"	106"	77"	49"	39,792	40	106
R-HYBRID 10-1575	10' 2"	3/4"	7/8"	1-1/8"	15.75"	14.17"	220	4"	234"	65"	106"	77"	50"	44,092	50	106
R-HYBRID 10-1772	10' 2"	1"	1 3/16"	1 5/8"	17.72"	16.54"	286	4-3/4"	240"	73"	114"	86"	57"	55,116	60	159
R-HYBRID 10-1969	10' 2"	1 3/16"	1 3/8"	1 7/8"	19.69"	18.11"	352	5-3/8"	248"	78"	121"	94"	61"	72,753	75	198
R-HYBRID 10-2205	10' 2"	1 3/8"	1 5/8"	2 5/32"	22.05"	19.69"	484	6"	258"	89"	139"	105"	69"	99,208	60+25	238
R-HYBRID 10-2440	10' 2"	2"	2 1/2"	3"	24.40"	22.04"	616	7"	354"	111"	173"	78"	118"	143,000	60+60	238
R-HYBRID 10-2677	10' 2"	2 1/2"	3"	3 1/2"	26.77"	23.62"	880	8"	362"	114"	178"	80"	120"	165,000	75+75	238
R-HYBRID 12-1377	12' 1"	1/2"	5/8"	1"	13.77"	12.99"	150	4"	238"	65"	106"	77"	49"	45,406	40	106
R-HYBRID 12-1575	12' 1"	5/8"	3/4"	1"	15.75"	14.17"	176	4"	274"	65"	106"	77"	50"	49,706	50	106
R-HYBRID 12-1772	12' 1"	3/4"	7/8"	1-1/8"	17.72"	16.54"	220	4-3/4"	280"	73"	114"	86"	57"	58,084	60	159
R-HYBRID 12-1969	12' 1"	1"	1 3/16"	1 9/16"	19.69"	18.11"	286	5-3/8"	287"	78"	121"	94"	61"	77,264	75	198
R-HYBRID 12-2205	12' 1"	1 1/8"	1 1/4"	1 3/4"	22.05"	19.69"	385	6"	297"	89"	139"	105"	69"	103,940	60+25	238
R-HYBRID 14-1377	14' 1"	3/8"	1/2"	3/4"	13.77"	12.99"	150	4"	262"	65"	106"	77"	49"	46,406	40	106
R-HYBRID 14-1575	14' 1"	1/2"	5/8"	1"	15.75"	14.17"	176	4"	274"	65"	106"	77"	50"	52,706	50	106
R-HYBRID 14-1772	14' 1"	3/4"	7/8"	1-1/8"	17.72"	16.54"	220	4-3/4"	280"	73"	114"	86"	57"	61,084	60	159
R-HYBRID 14-1969	14' 1"	1"	1 3/16"	1 9/16"	19.69"	18.11"	286	5-3/8"	287"	78"	121"	94"	61"	80,264	75	198
R-HYBRID 14-2205	14' 1"	1 1/8"	1 1/4"	1 3/4"	22.05"	19.69"	385	6"	297"	89"	139"	105"	69"	106,940	60+25	238

The values above as based on 38 KSI yield material.
 Different material widths and plate types can be calculated using the RMT Roll Bending Calculator.
 Conical bending capacities depend on cone angle and are half the above mentioned values.
 Motor power and machine weight will increase with optional features.
 Due to ongoing product development, specifications may change at any time.

**Larger or Custom
Machines Available**